

**TILTING BOLSTER
ADJUSTABLE CLAMP ON.
HYDRUALIC TILTING**

TO SUIT 160mm CENTRE'S
No 1 (FIRST BOLSTER)
600mm PEG SOCKETS

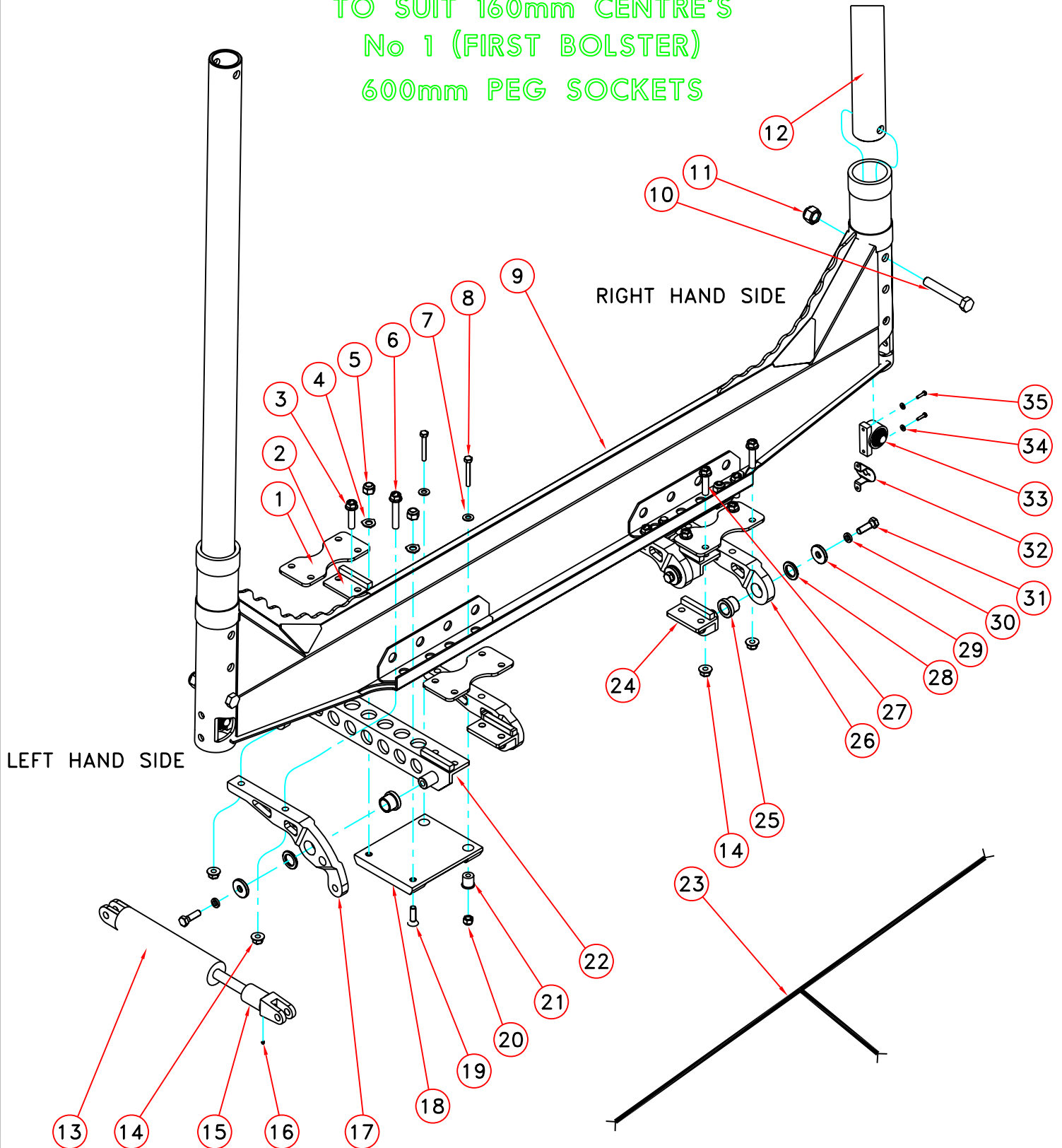



PARTLIST.DOT

COMPONENT: **TILTING BOLSTER (HYDRAULIC) No1 (First)**

INDEX	PART NO.	QTY	DESCRIPTION	SIZE
	30/043572	1	TILTING BOLSTER (Adjustable Clamp On) (Rearward Tilting)	
			INDEX 1 - 35	
1	30/043146	3	TOP CLAMP PLATE	
2	30/043185	1	BEAM CLAMP ASS'Y	
3	90/882510F	4	BOLT, Flange	2-1/2"x5/8"UNF
4	90/970010	4	WASHER, Flat-Hard. Zinc Plated	5/8"
5	90/789810	4	NUT, Nyloc. Zinc Plated	5/8"UNC
6	90/883510F	4	BOLT, Flange	3-1/2"x5/8"UNF
7	90/970008	8	WASHER, Flat-Hard. Zinc Plated	1/2"
8	90/783008	4	BOLT, Grade 8. Zinc Plated	3-1/2"x1/2"UNC
9	30/043172	1	BOLSTER, 600mm Peg Sockets (Drilled To Suit Tilting)	
10	90/785514	2	BOLT, Grade 8. Zinc Plated	5-1/2"x7/8"UNC
11	90/789814	2	NUT, Nyloc. Zinc Plated	7/8"UNC
12	30/041020-28	2	PEG, Round. 85 O.D x 67 I.D.	2.0 – 2.8mtr
13	16/SAG8X2	1	HYDRAULIC CYLINDER, (2" Bore x 8" Stroke)	
14	90/889910F	24	NUT, Flange	5/8"UNF
15	30/043510 or 30/043511	1	BEARING COLLAR, 67mm Long BEARING COLLAR, 79mm Long	
16	90/750404GS	1	GRUB SCREW	1/4"x1/4"UNC
17	30/043030	1	PIVOT ARM, Hydraulic	
18	30/043027	2	DUAL WEAR PAD	
19	90/782010CS	4	BOLT, Counter Sunk, Grade 8	2"x5/8"UNC
20	90/789808	4	NUT, Nyloc. Zinc Plated	1/2"UNC
21	30/043032	4	TOP HAT BUSH	
22	30/043599	1	PIVOT ANGLE ASS'Y, Hydraulic	
23	30/084580	1	WIRING HARNESS	
24	30/043598	2	PIVOT ANGLE ASS'Y, Non Hydraulic	
25	30/043029	4	WEARING BUSH	
26	30/043031	2	PIVOT ARM, Non Hydraulic	
27	90/882010F	16	BOLT, Flange	2"x5/8"UNF
28	30/043141	4	SPACER WASHER	
29	30/043505	4	CLAMP WASHER	
30	90/960010	4	WASHER, Spring. Zinc Plated	5/8"
31	90/782010	4	BOLT, Grade 8. Zinc Plated	2"x5/8"UNC
32	30/043508	2	MOUNT, LED Clearance Lamp (<i>If Fitted</i>)	
33	14/2006	2	CLEARANCE LAMP, (<i>Festoon Globe Type</i>)	
	14/2053EA	2	CLEARANCE LAMP, LED (<i>If Fitted</i>)	
34	90/990004	4	WASHER, Flat. Zinc Plated	1/4"
35	90/751004	4	BOLT, Grade 5. Zinc Plated	1"x1/4"UNC
			VOLTAGE:- 12VOLT Standard	
	14/L125	2	FESTOON GLOBE 12 Volt 5 Watt	
	14/L245	2	FESTOON GLOBE 24 Volt 5 Watt	

**TILTING BOLSTER
ADJUSTABLE CLAMP ON.
HYDRAULIC TILTING**

TO SUIT 160mm CENTRE'S
No 2 (SECOND BOLSTER)
600mm PEG SOCKETS

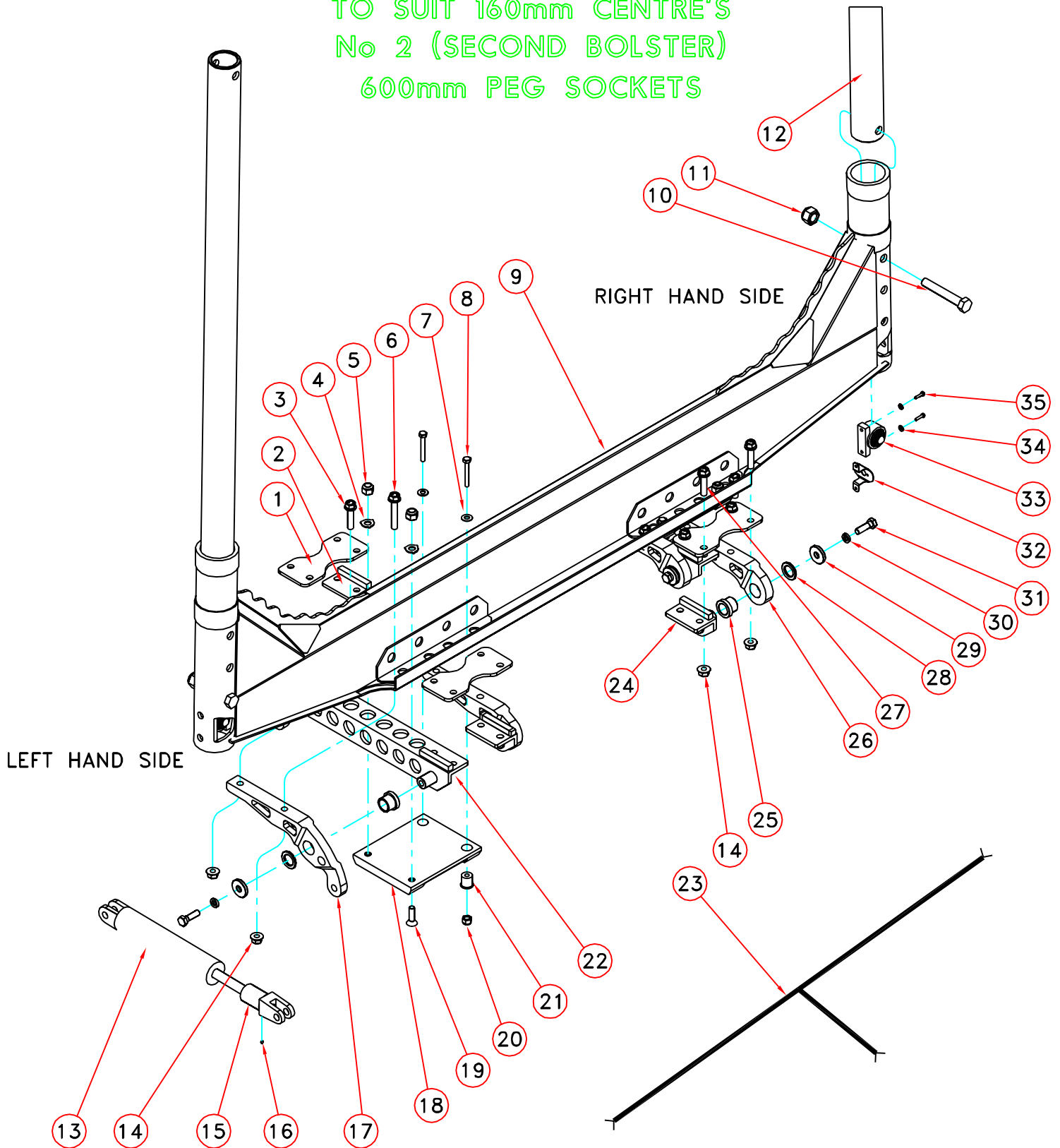



PARTLIST.DOT

COMPONENT: **TILTING BOLSTER (HYDRAULIC) No2 (Second)**

INDEX	PART NO.	QTY	DESCRIPTION	SIZE
	30/043571	1	TILTING BOLSTER (Adjustable Clamp On) (Rearward Tilting)	
			INDEX 1 - 35	
1	30/043146	3	TOP CLAMP PLATE	
2	30/043185	1	BEAM CLAMP ASS'Y	
3	90/882510F	4	BOLT, Flange	2-1/2"x5/8"UNF
4	90/970010	4	WASHER, Flat-Hard. Zinc Plated	5/8"
5	90/789810	4	NUT, Nyloc. Zinc Plated	5/8"UNC
6	90/883510F	4	BOLT, Flange	3-1/2"x5/8"UNF
7	90/970008	8	WASHER, Flat-Hard. Zinc Plated	1/2"
8	90/783008	4	BOLT, Grade 8. Zinc Plated	3-1/2"x1/2"UNC
9	30/043172	1	BOLSTER, 600mm Peg Sockets (Drilled To Suit Tilting)	
10	90/785514	2	BOLT, Grade 8. Zinc Plated	5-1/2"x7/8"UNC
11	90/789814	2	NUT, Nyloc. Zinc Plated	7/8"UNC
12	30/041020-28	2	PEG, Round. 85 O.D x 67 I.D.	2.0 – 2.8mtr
13	16/SAG8X2	1	HYDRAULIC CYLINDER, (2" Bore x 8" Stroke)	
14	90/889910F	24	NUT, Flange	5/8"UNF
15	30/043510 or 30/043511	1	BEARING COLLAR, 67mm Long BEARING COLLAR, 79mm Long	
16	90/750404GS	1	GRUB SCREW	1/4"x1/4"UNC
17	30/043030	1	PIVOT ARM, Hydraulic	
18	30/043027	2	DUAL WEAR PAD	
19	90/782010CS	4	BOLT, Counter Sunk, Grade 8	2"x5/8"UNC
20	90/789808	4	NUT, Nyloc. Zinc Plated	1/2"UNC
21	30/043032	4	TOP HAT BUSH	
22	30/043599	1	PIVOT ANGLE ASS'Y, Hydraulic	
23	30/084580	1	WIRING HARNESS	
24	30/043598	2	PIVOT ANGLE ASS'Y, Non Hydraulic	
25	30/043029	4	WEARING BUSH	
26	30/043031	2	PIVOT ARM, Non Hydraulic	
27	90/882010F	16	BOLT, Flange	2"x5/8"UNF
28	30/043141	4	SPACER WASHER	
29	30/043505	4	CLAMP WASHER	
30	90/960010	4	WASHER, Spring. Zinc Plated	5/8"
31	90/782010	4	BOLT, Grade 8. Zinc Plated	2"x5/8"UNC
32	30/043508	2	MOUNT, LED Clearance Lamp (<i>If Fitted</i>)	
33	14/2006	2	CLEARANCE LAMP, (<i>Festoon Globe Type</i>)	
	14/2053EA	2	CLEARANCE LAMP, LED (<i>If Fitted</i>)	
34	90/990004	4	WASHER, Flat. Zinc Plated	1/4"
35	90/751004	4	BOLT, Grade 5. Zinc Plated	1"x1/4"UNC
			VOLTAGE:- 12VOLT Standard	
	14/L125	2	FESTOON GLOBE 12 Volt 5 Watt	
	14/L245	2	FESTOON GLOBE 24 Volt 5 Watt	

**TILTING BOLSTER
ADJUSTABLE CLAMP ON.
HYDRAULIC TILTING**

TO SUIT 160mm CENTRE'S
No 3 (THIRD BOLSTER)
600mm PEG SOCKETS

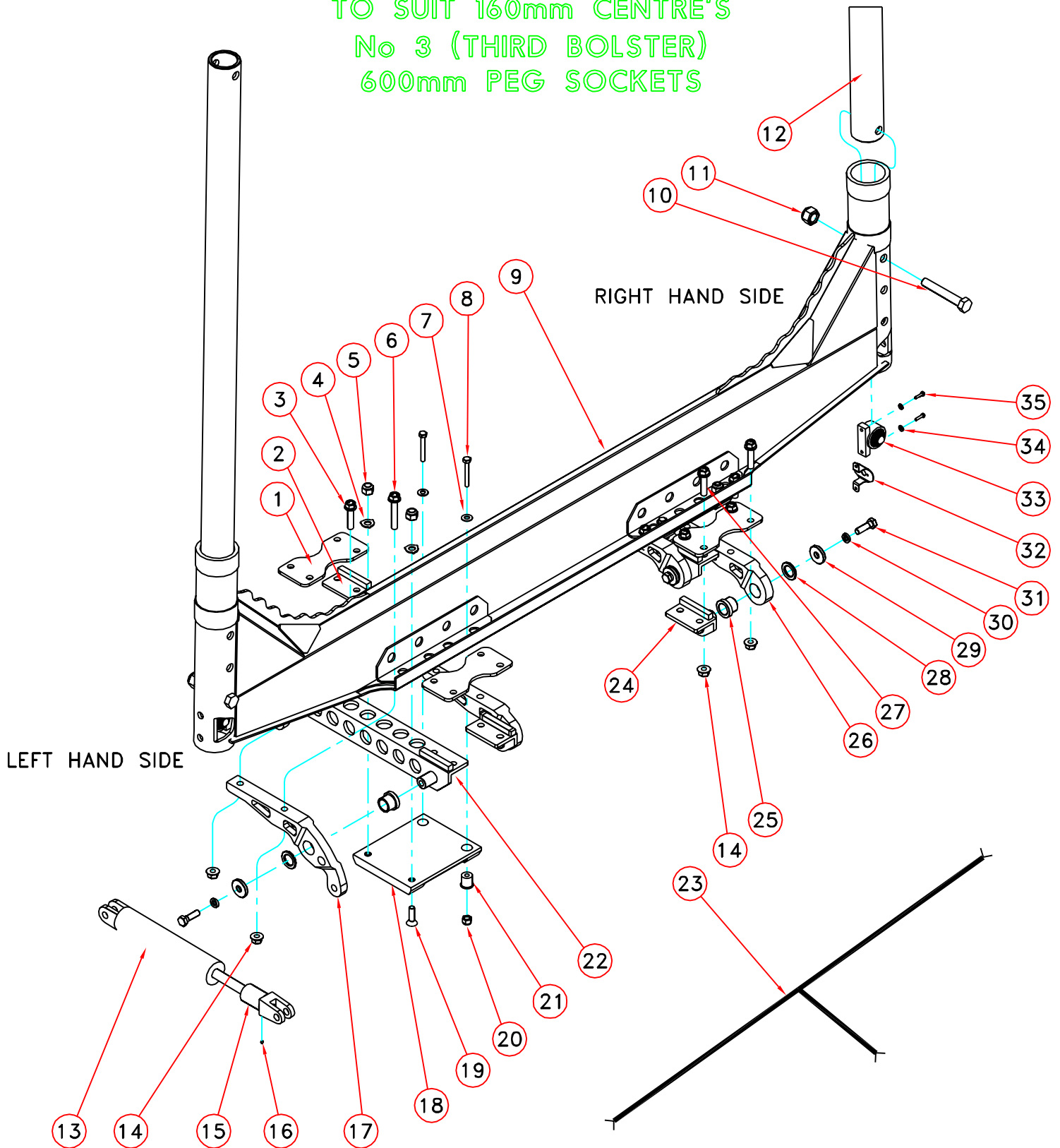



PARTLIST.DOT

COMPONENT: **TILTING BOLSTER (HYDRAULIC) No3 (Third)**

INDEX	PART NO.	QTY	DESCRIPTION	SIZE
	30/043570	1	TILTING BOLSTER (Adjustable Clamp On) (Rearward Tilting)	
			INDEX 1 - 35	
1	30/043146	3	TOP CLAMP PLATE	
2	30/043185	1	BEAM CLAMP ASS'Y	
3	90/882510F	4	BOLT, Flange	2-1/2"x5/8"UNF
4	90/970010	4	WASHER, Flat-Hard. Zinc Plated	5/8"
5	90/789810	4	NUT, Nyloc. Zinc Plated	5/8"UNC
6	90/883510F	4	BOLT, Flange	3-1/2"x5/8"UNF
7	90/970008	8	WASHER, Flat-Hard. Zinc Plated	1/2"
8	90/783008	4	BOLT, Grade 8. Zinc Plated	3-1/2"x1/2"UNC
9	30/043172	1	BOLSTER, 600mm Peg Sockets (Drilled To Suit Tilting)	
10	90/785514	2	BOLT, Grade 8. Zinc Plated	5-1/2"x7/8"UNC
11	90/789814	2	NUT, Nyloc. Zinc Plated	7/8"UNC
12	30/041020-28	2	PEG, Round. 85 O.D x 67 I.D.	2.0 – 2.8mtr
13	16/SAG8X2	1	HYDRAULIC CYLINDER, (2" Bore x 8" Stroke)	
14	90/889910F	24	NUT, Flange	5/8"UNF
15	30/043510 or 30/043511	1	BEARING COLLAR, 67mm Long BEARING COLLAR, 79mm Long	
16	90/750404GS	1	GRUB SCREW	1/4"x1/4"UNC
17	30/043030	1	PIVOT ARM, Hydraulic	
18	30/043027	2	DUAL WEAR PAD	
19	90/782010CS	4	BOLT, Counter Sunk, Grade 8	2"x5/8"UNC
20	90/789808	4	NUT, Nyloc. Zinc Plated	1/2"UNC
21	30/043032	4	TOP HAT BUSH	
22	30/043599	1	PIVOT ANGLE ASS'Y, Hydraulic	
23	30/084580	1	WIRING HARNESS	
24	30/043598	2	PIVOT ANGLE ASS'Y, Non Hydraulic	
25	30/043029	4	WEARING BUSH	
26	30/043031	2	PIVOT ARM, Non Hydraulic	
27	90/882010F	16	BOLT, Flange	2"x5/8"UNF
28	30/043141	4	SPACER WASHER	
29	30/043505	4	CLAMP WASHER	
30	90/960010	4	WASHER, Spring. Zinc Plated	5/8"
31	90/782010	4	BOLT, Grade 8. Zinc Plated	2"x5/8"UNC
32	30/043508	2	MOUNT, LED Clearance Lamp (If Fitted)	
33	14/2006	2	CLEARANCE LAMP, (Festoon Globe Type)	
	14/2053EA	2	CLEARANCE LAMP, LED (If Fitted)	
34	90/990004	4	WASHER, Flat. Zinc Plated	1/4"
35	90/751004	4	BOLT, Grade 5. Zinc Plated	1"x1/4"UNC
			VOLTAGE:- 12VOLT Standard	
	14/L125	2	FESTOON GLOBE 12 Volt 5 Watt	
	14/L245	2	FESTOON GLOBE 24 Volt 5 Watt	

**TILTING BOLSTER
ADJUSTABLE CLAMP ON
HYDRAULIC TILTING. TWIN CYLINDERS**

TO SUIT 160mm CENTRE'S
No 4 (FOURTH BOLSTER)
600mm PEG SOCKETS

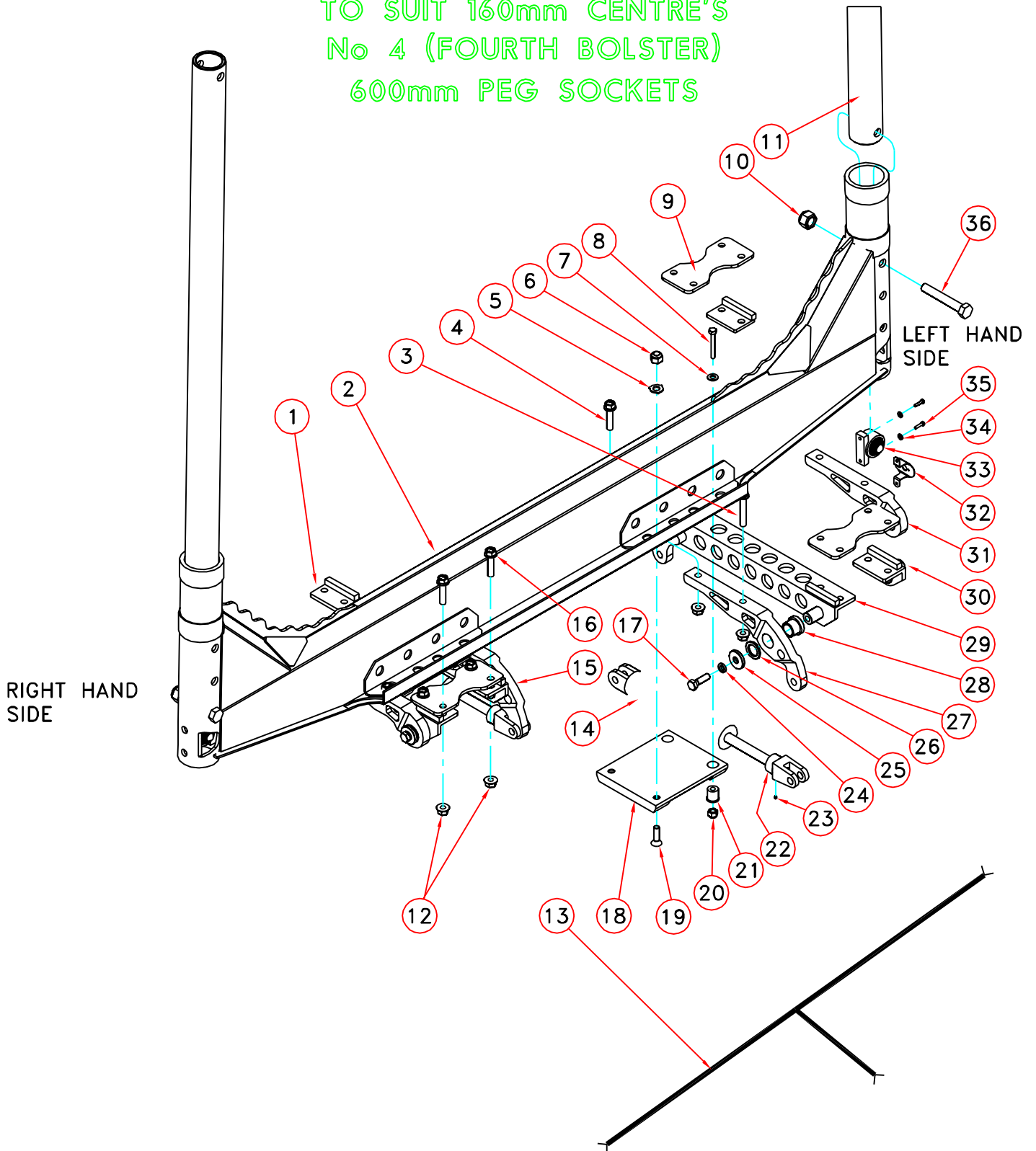



PARTLIST.DOT

COMPONENT: **TILTING BOLSTER (HYDRAULIC) No 4 (Fourth) TWIN CYLINDERS**

INDEX	PART NO.	QTY	DESCRIPTION	SIZE
	30/043568	1	TILTING BOLSTER (Adjustable Clamp On) Twin Cylinders (Forward Tilting) INDEX 1 - 36	
1	30/043185	2	BEAM CLAMP ASS'Y	
2	30/043172	1	BOLSTER, 600mm Peg Sockets (Drilled To Suit Tilting)	
3	90/883510F	4	BOLT, Flange	3-1/2"x5/8"UNF
4	90/882510F	4	BOLT, Flange	2-1/2"x5/8"UNF
5	90/970010	4	WASHER, Flat-Hard. Zinc Plated	5/8"
6	90/789810	4	NUT, Nyloc. Zinc Plated	5/8"UNC
7	90/970008	4	WASHER, Flat-Hard. Zinc Plated	1/2"
8	90/783008	4	BOLT, Grade 8. Zinc Plated	3"x1/2"UNC
9	30/043146	4	TOP CLAMP PLATE	
10	90/789814	2	NUT, Nyloc. Zinc Plated	7/8"UNC
11	30/041020-28	2	PEG, Round 85 O.D x 67 I.D	2.0 - 2.8mtr
12	90/889910F	24	NUT. Flange	5/8"UNF
13	30/084580	1	WIRING HARNESS	
14	16/SAG2X8	2	HYDRAULIC CYLINDER (2" Bore x 8" Stroke)	
15	30/043030-M	1	PIVOT ARM, Hydraulic, Mirrored	
16	90/882210F	16	BOLT, Flange	2-1/4"x5/8"UNF
17	90/782010	4	BOLT, Grade 8. Zinc Plated	2"x5/8"UNC
18	30/043027	2	DUAL WEAR PAD, Suit Sliding & Tilting	
19	90/782510CS	4	BOLT, Countersunk. Grade 8	2-1/2"x5/8"UNC
20	90/789808	4	NUT, Nyloc. Zinc Plated	1/2"UNC
21	30/043032	4	TOP HAT BUSH	
22	30/043512	2	BEARING COLLAR, 25mm Long	
23	90/750404GS	2	GRUB SCREW	1/4"x1/4"UNC
24	90/960010	4	WASHER, Spring. Zinc Plated	5/8"
25	30/043505	4	CLAMP WASHER	
26	30/043141	4	SPACER WASHER	
27	30/043030	1	PIVOT ARM, Power, Hydraulic	
28	30/043029	4	WEARING BUSH	
29	30/043599	1	PIVOT ANGLE ASS'Y, Hydraulic	
	30/043576	1	PIVOT ANGLE ASS'Y, Hydraulic. Mirrored	
30	30/043598	2	PIVOT ANGLE ASS'Y, Non Hydraulic	
31	30/043031	2	PIVOT ARM, Non Power, Milled, Non Hydraulic	
32	30/043508	2	MOUNT, LED Clearance Lamp (If Fitted)	
33	14/2006	2	CLEARANCE LAMP, (Festoon Globe Type)	
	14/2053EA		CLEARANCE LAMP, LED (If Fitted)	
34	90/990004	4	WASHER, Flat. Zinc Plated	1/4"
35	90/751004	4	BOLT, Grade 5. Zinc Plated	1"x1/4"UNC
36	90/785514	2	BOLT, Grade 8. Zinc Plated	5-1/2"x7/8"UNC
			VOLTAGE:- 12VOLT Standard	
	14/L125	2	FESTOON GLOBE 12 Volt 5 Watt	
	14/L245	2	FESTOON GLOBE 24 Volt 5 Watt	