

PROUDLY AUSTRALIAN

ELPHINSTONE

WEIGHING SYSTEMS
LOGGING TRAILERS

Elphinstone Engineering Aust. Pty. Ltd. ACN 009 533 984

Trading as: **Elphinstone Engineering**

Head Office - Tasmania

PH. (03) 6257 3242

FAX. (03) 6257 3573

Victoria

PH. (03) 9311 6366

FAX. (03) 9311 6466

Western Australia **Queensland**

1800 030 019

E-mail: tri.office@elph.com.au

E-mail: vic.office@elph.com.au

Internet Site: www.elph.com.au

Version 4-September 2012

LOAD BINDER WINCHES – AUTO TENSIONER (AIR WINCH) ***PART NO 30/303899***



Ref: Air winch operation V4.doc

Manufacturers and Installers of Elphinstone
On-Vehicle and Stationary Weighing Systems, Logging Trailers and Equipment since 1976

PROUDLY AUSTRALIAN

ELPHINSTONE

WEIGHING SYSTEMS
LOGGING TRAILERS

Elphinstone Engineering Aust. Pty. Ltd. ACN 009 533 984

Trading as: **Elphinstone Engineering**

Head Office - Tasmania

PH. (03) 6257 3242

FAX. (03) 6257 3573

Victoria

PH. (03) 9311 6366

FAX. (03) 9311 6466

Western Australia

Queensland

1800 030 019

E-mail: tri.office@elph.com.au

E-mail: vic.office@elph.com.au

Internet Site: www.elph.com.au

Version 4-September 2012

NORMAL OPERATION

1. Release locking pawls (2 of).



2. This allows drum to run free and strap can be pulled off drum.



3. Throw over load, hook up to anchor point on other side of trailer.



4. Roll up loose strap on winch drum.



Ref: Air winch operation V4.doc

PROUDLY AUSTRALIAN

ELPHINSTONE

WEIGHING SYSTEMS
LOGGING TRAILERS

Elphinstone Engineering Aust. Pty. Ltd. ACN 009 533 984

Trading as: **Elphinstone Engineering**

Head Office - Tasmania

PH. (03) 6257 3242

FAX. (03) 6257 3573

Victoria

PH. (03) 9311 6366

FAX. (03) 9311 6466

Western Australia **Queensland**

1800 030 019

E-mail: tri.office@elph.com.au

E-mail: vic.office@elph.com.au

Internet Site: www.elph.com.au

Version 4-September 2012

5. Engage both pawls (2). Turn on control located on opposite side to pawls. Left hand side turn clockwise. **Note winch is operating.**



- 6 It will take up and tension and stop when reaches tension. Air supply can have regulator fitted (recommended. If air filter and regulator are fitted and by use of regulator tension can be varied to suit load being carried. Normally would run approximately 6-7 bar.

TO RELEASE

- i. While air still turned on release bottom pawl. Pull up on pawl handle and slide pawl in - away from you to unlock position.



- ii. Turn off air control valve (give it time to exhaust air). Second pawl can be released (If there is too much spring back in load and second pawl is too tight to released you need to use winch handle to release pressure so second pawl can be released)



Ref: Air winch operation V4.doc

PROUDLY AUSTRALIAN

ELPHINSTONE

WEIGHING SYSTEMS
LOGGING TRAILERS

Elphinstone Engineering Aust. Pty. Ltd. ACN 009 533 984

Trading as: **Elphinstone Engineering**

Head Office - Tasmania

PH. (03) 6257 3242

FAX. (03) 6257 3573

Victoria

PH. (03) 9311 6366

FAX. (03) 9311 6466

Western Australia **Queensland**

1800 030 019

E-mail: tri.office@elph.com.au

E-mail: vic.office@elph.com.au

Internet Site: www.elph.com.au

Version 4-September 2012

(If it is necessary to use handle make sure there are no loose parts or load hanging in strap that could fall on operator

- iii. Release anchored end of strap by remote release if fitted or by going to the anchor point and releasing.



- iv. Roll up strap onto drum.

- v. Hook end of strap onto anchor lug on winch.



- vi. Engage both pawls. Controls can be turned on and winch will tension or can be tightened by hand



Ref: Air winch operation V4.doc

PROUDLY AUSTRALIAN



Elphinstone Engineering Aust. Pty. Ltd. ACN 009 533 984

Trading as: **Elphinstone Engineering**

Head Office - Tasmania

PH. (03) 6257 3242

FAX. (03) 6257 3573

E-mail: tri.office@elph.com.au

Victoria

PH. (03) 9311 6366

FAX. (03) 9311 6466

E-mail: vic.office@elph.com.au

Western Australia Queensland

1800 030 019

Internet Site: www.elph.com.au

Version 4-September 2012

LOAD BINDER WINCHES – AUTO TENSIONER (AIR WINCH)

GENERAL OVERVIEW

Elphinstone air load binder/winch is an air operated auto tensioner. It has a lashing capacity of 5000 kg. Tested to AS/NZS-4380:2001 Motor Vehicles – Cargo Restraint Systems

When in place with strap over load and control valve turned on winch will take up tension on strap and maintain constant pressure on strap. If the load moves or compacts, winch will automatically take up.

If there is any problem with air supply or controls winch will lock as if it is a manual winch. Winch can be used as a manual winch.

Ref: Air winch operation V4.doc

WINCH ASS'Y - TIE DOWN AIR OPERATED WINCH (From JAN 2010)

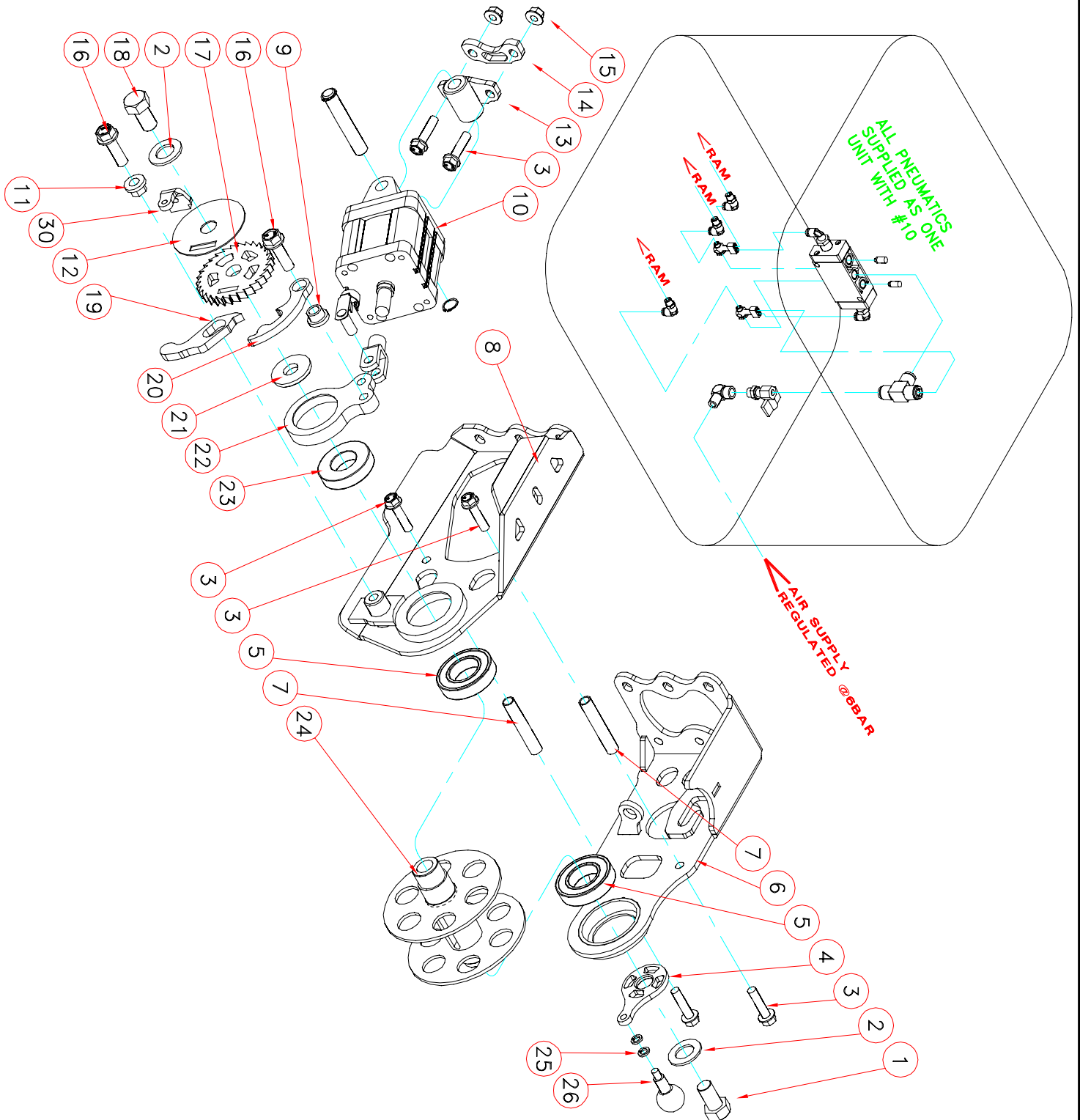



PARTLIST.DOT

COMPONENT: **WINCH ASS'Y - TIE DOWN (From JAN 2010)**

INDEX	PART NO.	QTY	DESCRIPTION	SIZE
	30/303899	1	WINCH ASS'Y – AIR OPERATED Consists Of Index No's 1 – 26	
1	90/YA1G81698015	1	SET SCREW. Grade 8. Zinc Plated (<i>Left Hand Thread</i>)	1"UNS-14 x 1-1/2"
2	90/IWSHR2HT1602	2	WASHER. Hard Flat Structural. Zinc Plated	1"
3	90/IF1G80888015	10	FLANGE BOLT. SAE Grade 8	1/2"UNF x 1-1/2"
4	30/177915B	1	HANDLE. Winding	
5	18/6209	2	BEARING	
6	30/303898	1	SIDE PLATE ASS'Y. Right Hand	
7	30/303704	2	TIE BAR	
8	30/303897	1	SIDE PLATE ASS'Y. Left Hand	
9	30/303719	1	BUSH. Driving Pawl suits 30/303760A	
10	12/SPAU60039PAC	1	CUSTOM Compact Cylinder 100mm Unit	
11	30/303721	1	BUSH. Stopper Pawl suits 30/303761	
12	30/177958	1	STAINLESS Steel Cover Plate To Suit 30/177909B	
13	30/303896	1	BUSH	
14	30/303803	1	SPACER	
15	90/889908F	2	NUT. Flange	1/2" UNC
16	90/IF1G81088020	2	FLANGE BOLT. SAE Grade 8	5/8"UNF x 2"
17	30/177909B	1	GEAR WHEEL	
18	90/IA1G81698020	1	SET SCREW. Grade 8. Zinc Plated (<i>Right Hand Thread</i>)	1"UNS-14 x 2"
19	30/303761B	1	PAWL. Stopper	
20	30/303760A	1	PAWL. Drive	
21	30/303749A	1	SPACER	
22	30/303809	1	ARM. Intermediate	
23	18/6208	1	BEARING	
24	30/303775C	1	DRUM ASS'Y	
25	90/MWSPR2HT10FS	1	WASHER. Spring. Zinc Plated	M10
26	18/GN319240M10	1	KNOB. Revolving	
27	30/177922B	1	Optional Part. (<i>Only fitted when winch is mounted on rear of bolster</i>) HANDLE. (<i>Left Hand Turning</i>)	